



# BIKE SURF

(Personal Water Craft)

## ASSEMBLY INSTRUCTIONS

Unboxing, assembly, warnings & precautions



**GB: WARNING** If you don't understand something please contact to Red Shark bikes.



**ES: IMPORTANTE** Si no entiende algo, por favor contacte con Red Shark Bikes.



**F: IMPORTANT** Si vous ne comprenez pas quelque chose, veuillez contacter Red Shark Bikes.



**DE: ACHTUNG** Wenn Sie etwas nicht verstehen, wenden Sie sich bitte an Red Shark Bikes.



**I: IMPORTANTE** se non capisci qualcosa, contatta Red Shark Bikes.



**P: IMPORTANTE** Se você não entender alguma coisa, entre em contato com a Red Shark Bikes.



**RUS: ВАЖНО** Если вы что-то не понимаете, пожалуйста, свяжитесь с Red Shark Bikes.



**NL: BELANGRIJK** als u iets niet begrijpt, neem dan contact op met Red Shark Bikes



**S: VIKTIGT** Om du inte förstår något, vänligen kontakta Red Shark Bikes.



**JP: 重要**なことがわからない場合は、RedShark Bikesにお問い合わせください。

### **Before anything, read user's manuals**

of this water bike to ensure correct usage through understanding. After reading, store them in a safe place for future reference. Incorrect handling of this product could possibly result in personal injury or physical damage. The manufacturer assumes no responsibility for any damage caused by mishandling that is beyond normal usage defined in these manuals of this water bike



ADVENTURE model

FITNESS model

ENJOY model

# ENJOY model





# FITNESS model



# ADVENTURE model





# UNBOXING



**1.** Open the box at the top and carefully remove all parts from the box.



**2.** Remove all plastic bags.

**WARNING:** Plastic bags can be dangerous. To avoid any risk of suffocation, keep all bags out of the reach of all babies, children and pets. Do not use in cribs, beds, strollers, or playpens. Tear the bag before throwing it away.



**3.** Read the packing list (taped outside the box) and confirm all items



# ENJOY model





# FITNESS model

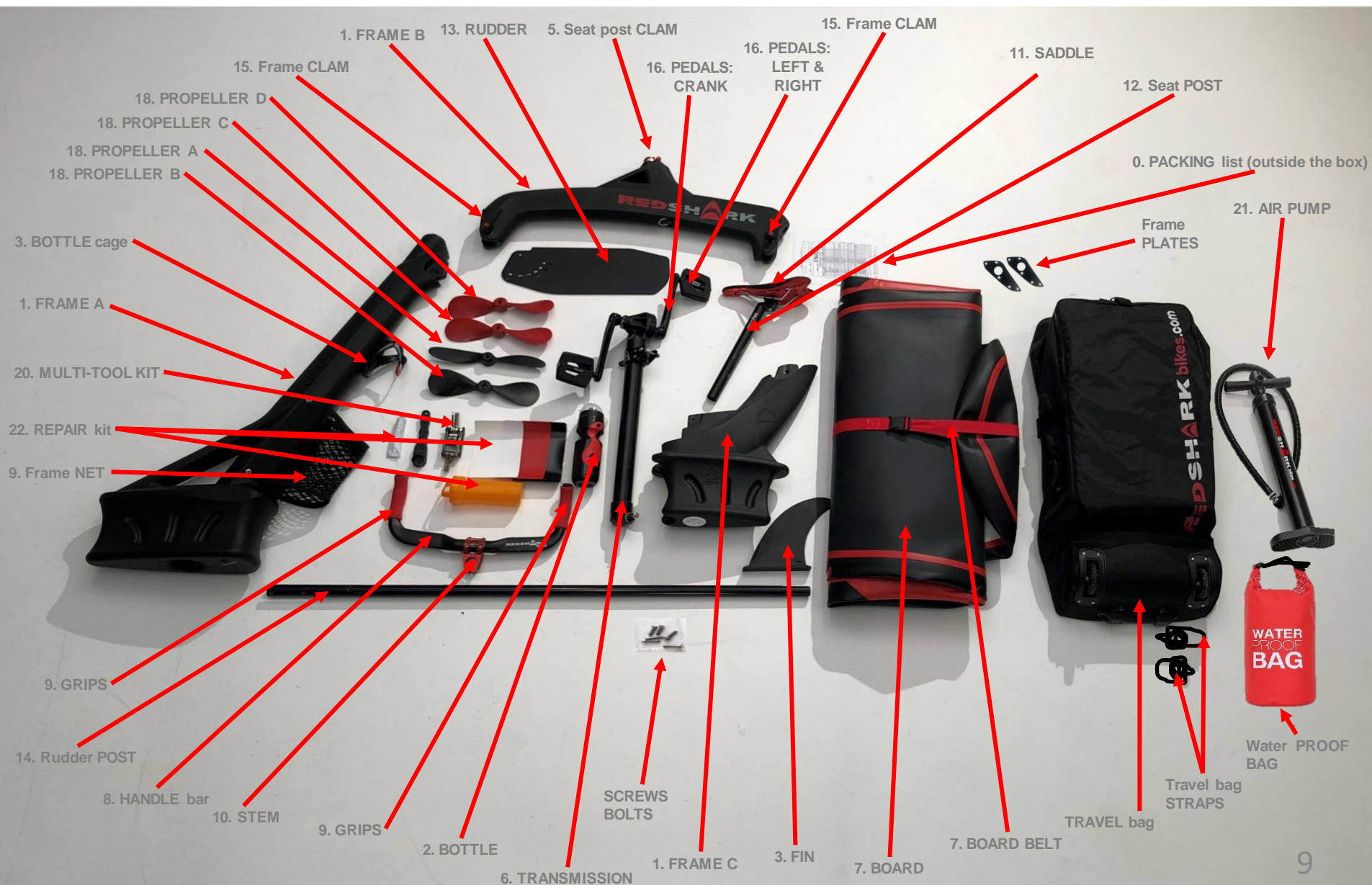

# ADVENTURE model



# NUTS, screws and others

2



4



2



2



OPTIONAL:  
For a permanent frame  
assembly

10



2

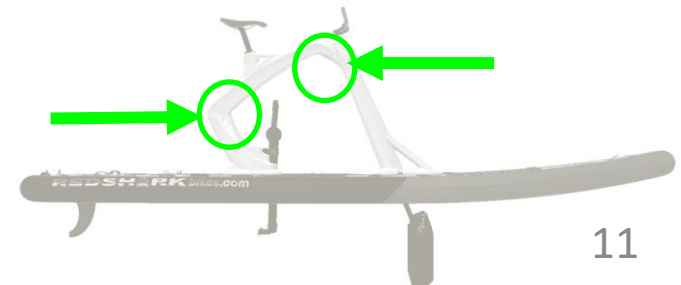



## 4. BOARD assembly

### 4.1. Extend the board



## 4. BOARD assembly (Puff up /step 1 from 2)

4.2. Use the AIR PUMP to have only a LITTLE PRESSURE to get the basic shape.

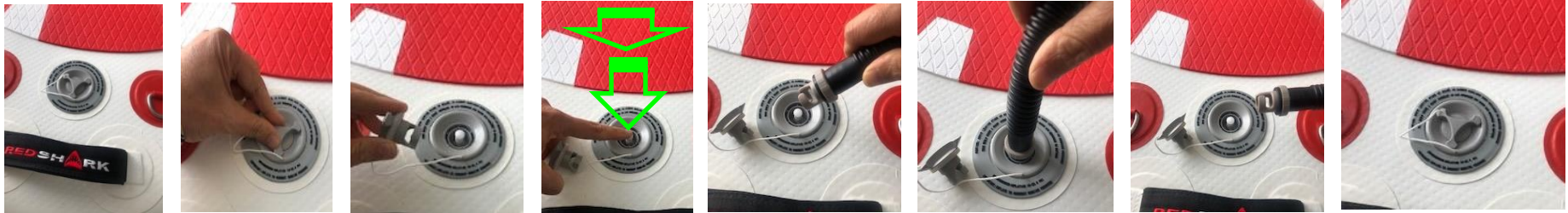

Unscrew the cap.

Check the position of the valve spout  
Press 1 time or 2 times

Insert the air pump

Puff up the air to 1 psi

Remove the air pump



Puff up to:

**0,5 psi** (approx.)

board must be soft



### KEEP ATTENTION:

The A & B Holes surface: must be completely clean from dust, sand and other dirty elements. If not it could damage on the board skin.

If you find air leakage on the valve, use the black tool (included on the repair kit tools) to tight or to disassemble the valve and check if is dirty and you can clean it .

## 5. FRAME assembly

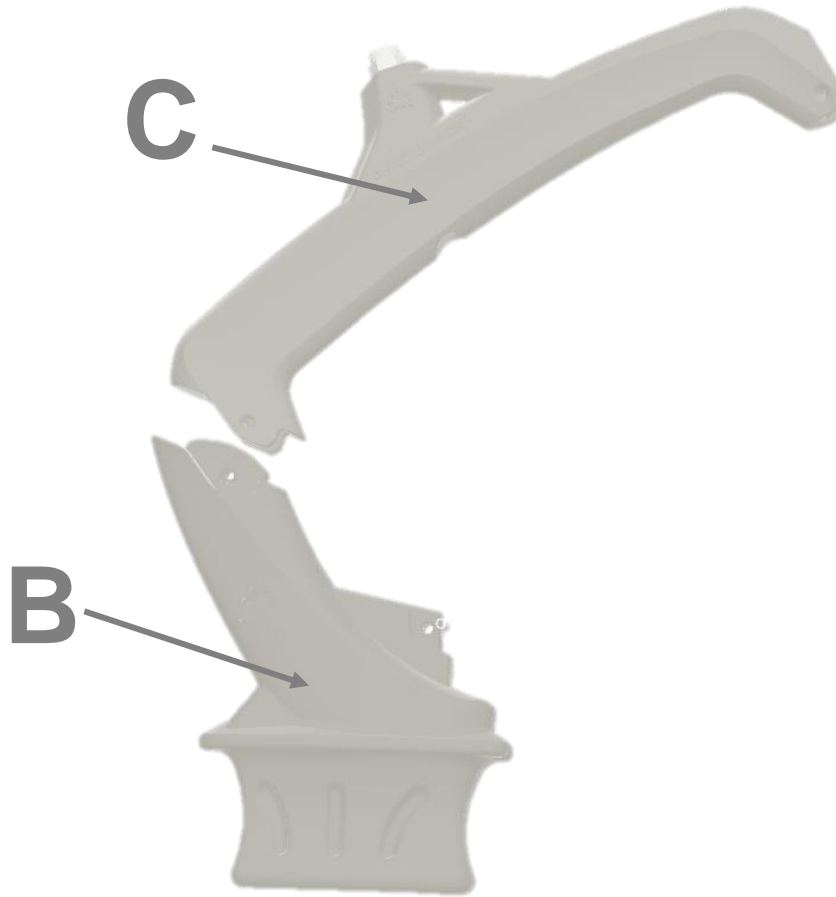

5.1 CHOSE the frame piece "A":

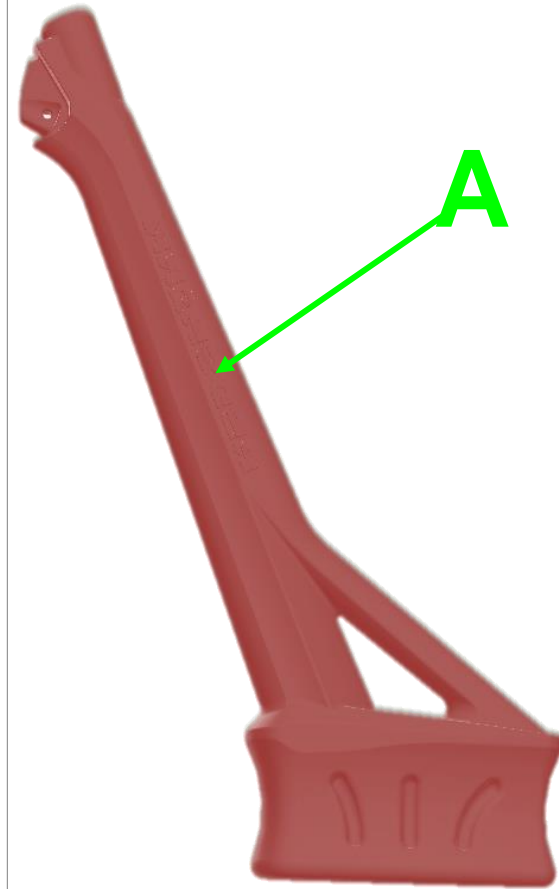



# ASSEMBLY INSTRUCTIONS



## 5. FRAME assembly

In the FRONT HOLE



Board with soft air pressure **0,5 psi**



### KEEP ATTENTION:

The **A & B Holes** surface, must be completely clean from dust, sand and other dirty elements. If not it could generate damages on the board skin. Please clean always before.

AVOID THE INTERFERENCES from the rudder and propeller with the board surface (holes A and B) if not it could generate damages on the board.

Suggestion: You can use a cloth rag to cover the rudder.

### 5.1 INSERT the frame "A" from the deck (TOP side)

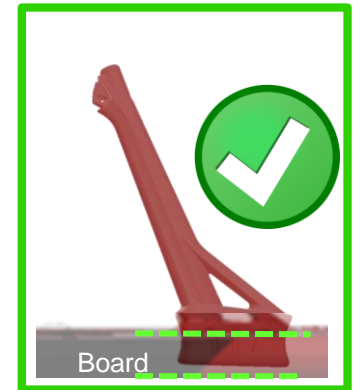

RECOMMENDATION: Please use a small STOOL (not included).

## 6. HANDLEBAR assembly: **ENJOY & ADVENTURE** models.

6.1 Insert the grips in the handlebar

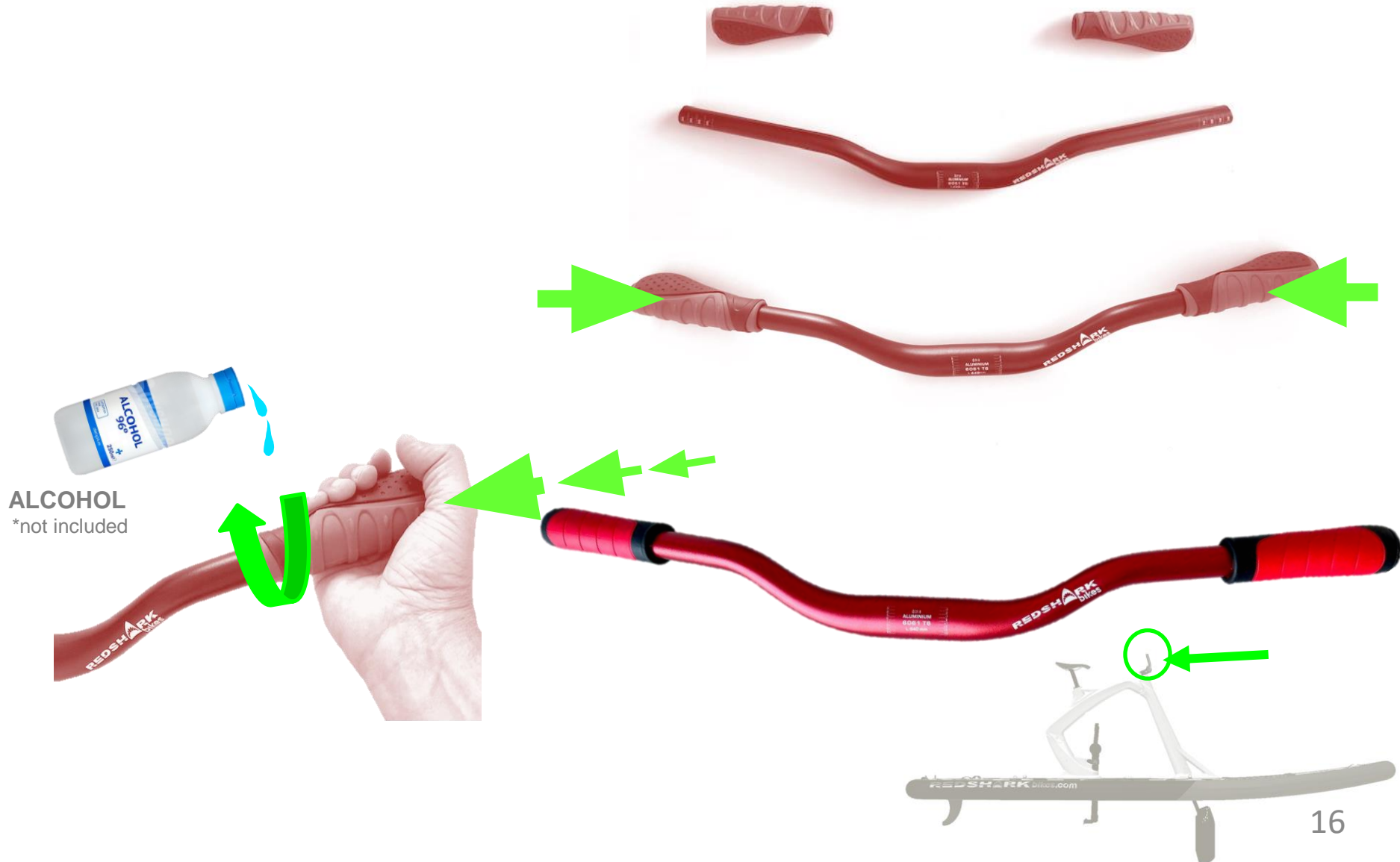

# ASSEMBLY INSTRUCTIONS

## 6. HANDLEBAR assembly



6.1 Insert the handlebar in the STEM



6.2 TIGHT the 4 screws:

TORQUE SPECIFICATIONS:



6 Newtons





## 6. HANDLEBAR assembly: **FITNESS** model.

### 6.1 Insert the grips in the handlebar

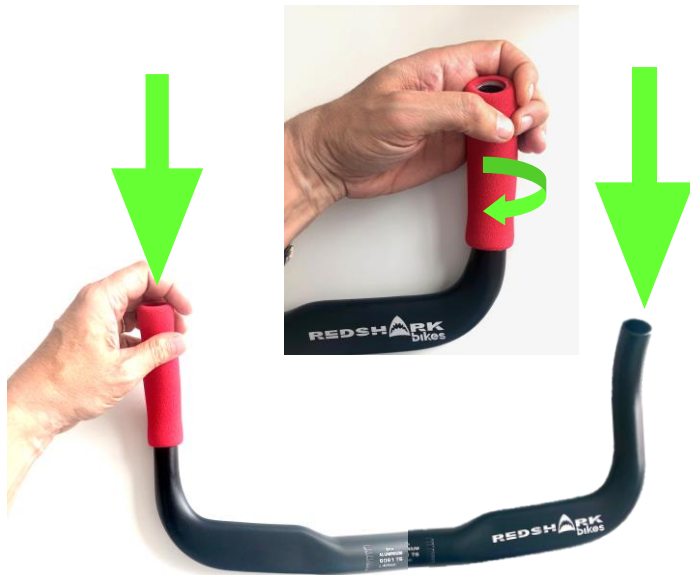

# ASSEMBLY INSTRUCTIONS

## 6. HANDLEBAR assembly: FITNESS model.

### 6.1 Insert the handlebar in the STEM



### 6.2 TIGHT the 4 screws:

TORQUE SPECIFICATIONS:



6 Newtons



## 7. RUDDER assembly

7.1 Insert the rudder BAR in to the frame

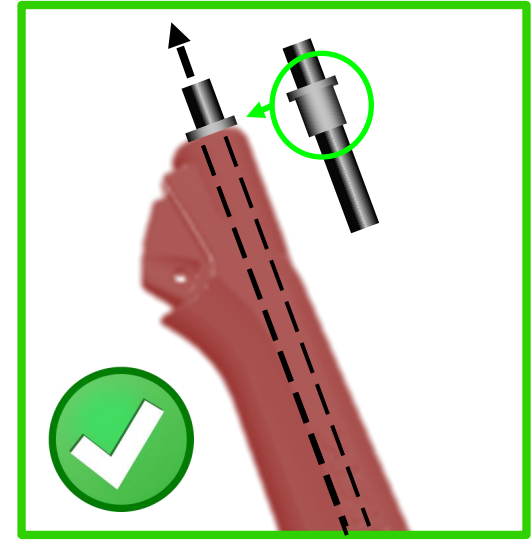
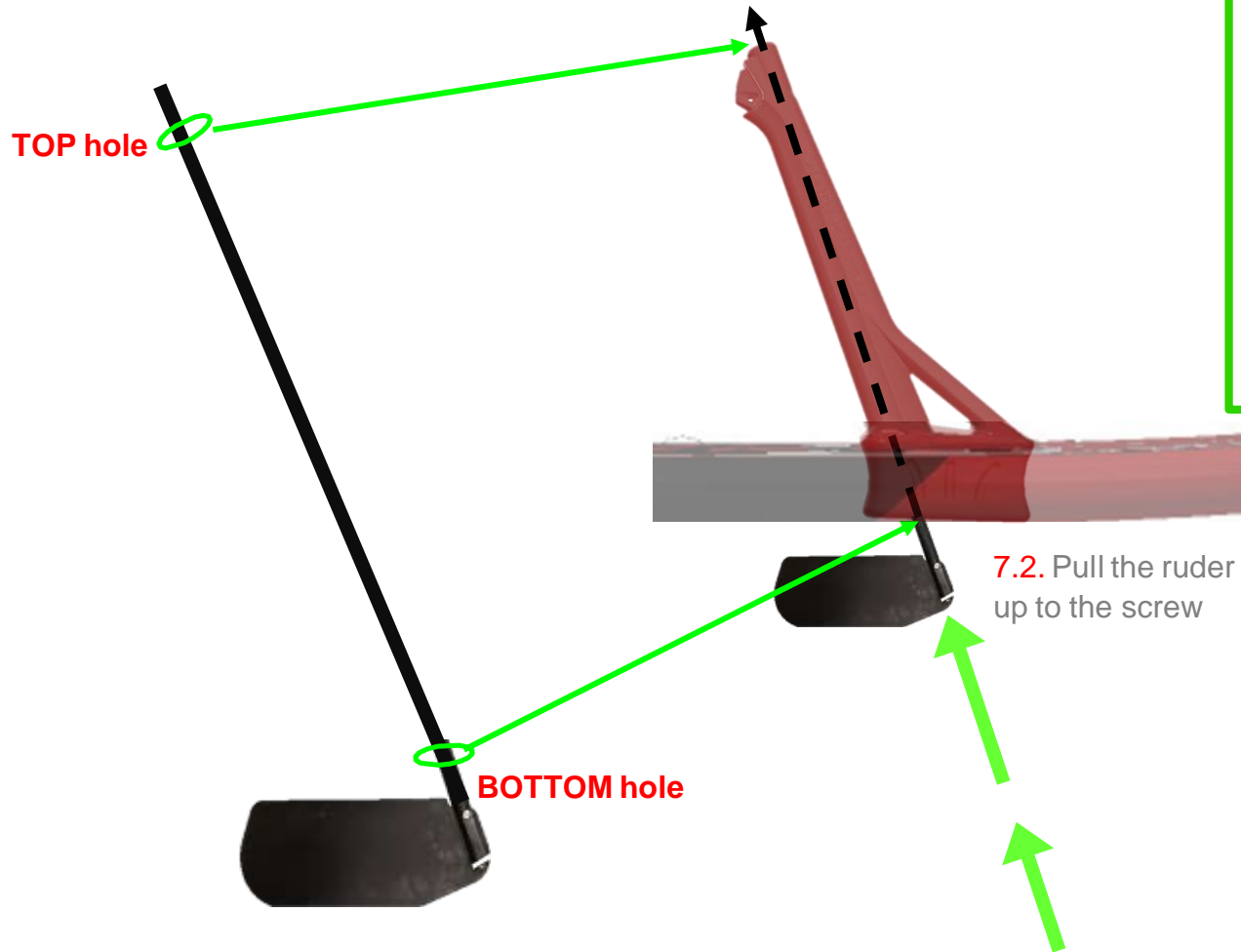

7.2. Pull the ruder post up to the screw

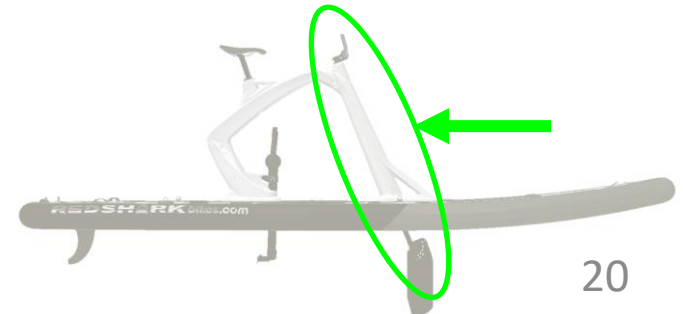



# ASSEMBLY INSTRUCTIONS

## 7. RUDDER assembly

7.3 Insert the rudder post to the STEM

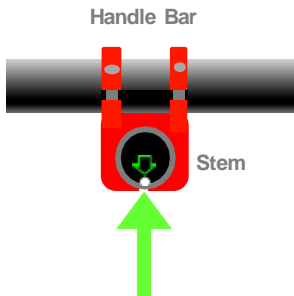
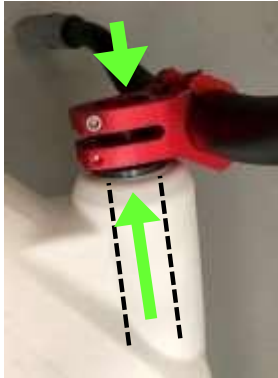

**ALIGNMENT WITH THE RUDDER bar**  
With the white mark in the center of the stem.

7.4 Line up the handle bar with the rudder.



Enjoy & Adventure model



Fitness model

7.5 Tight the 2 screws





**TORQUE SPECIFICATIONS:**

**6 Newtons**





## 7. RUDDER assembly

RUDDER FUNCTION

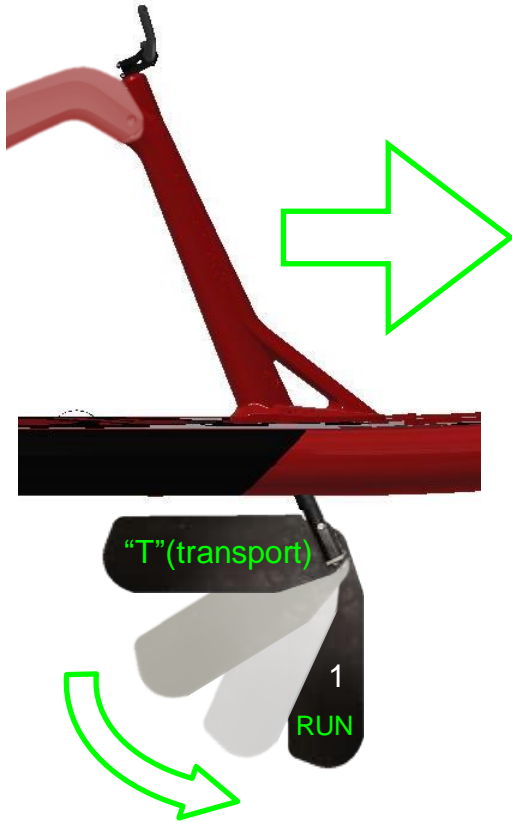

### 7.6 Unscrew wing nut



### 7.7 Chose the position

POSITIONS:

- T: transport
- I: level1
- II: Level 2
- III: Level 3



### 7.8 Screw wing nut

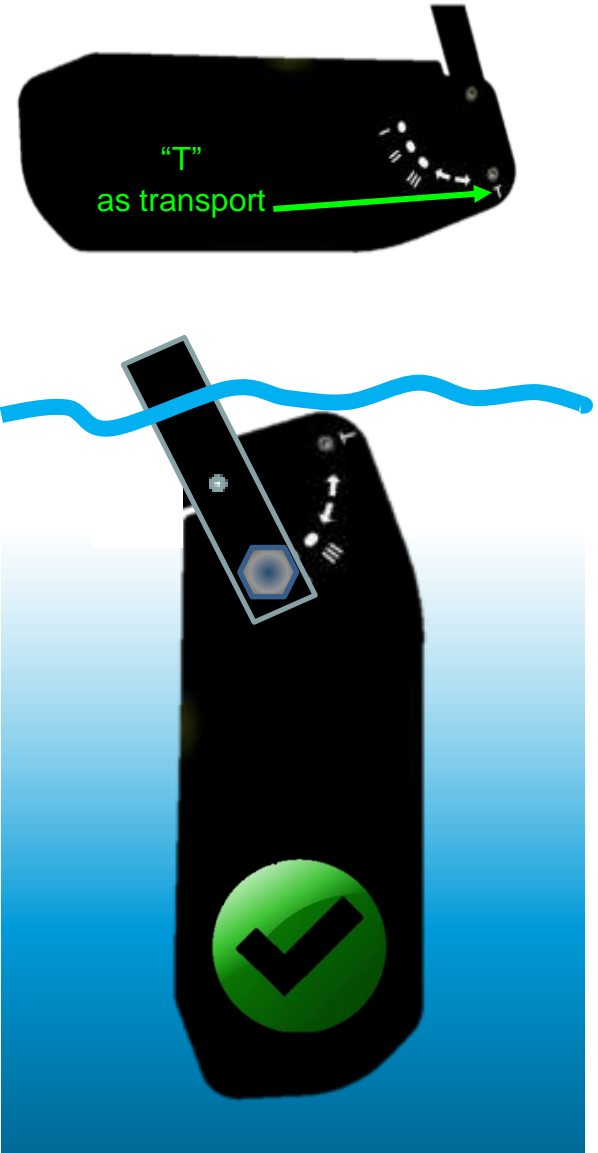

TIGHT the wing nut:

TORQUE SPECIFICATIONS:



3 Newtons



## 8. FRAME "B" assembly

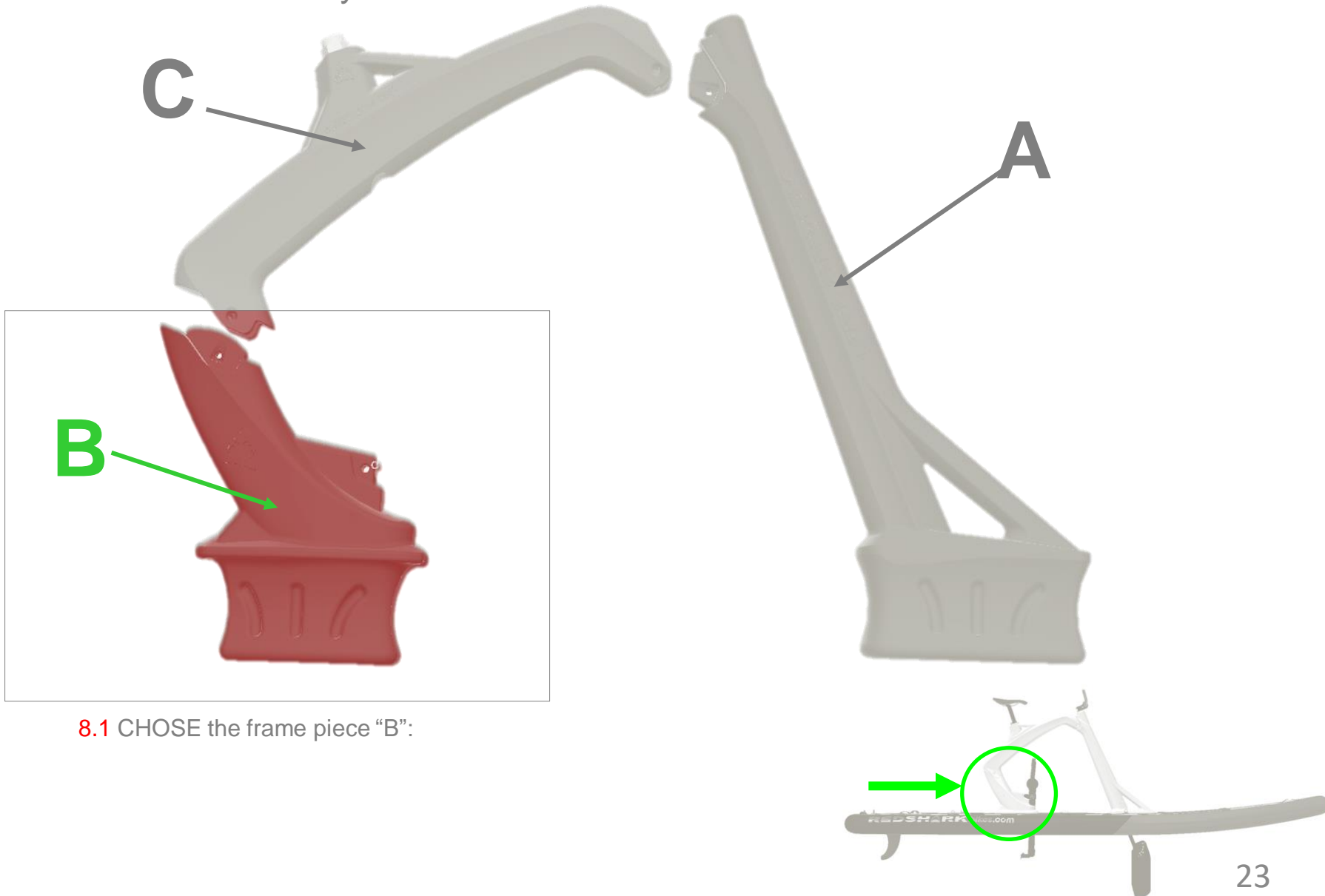

8.1 CHOSE the frame piece "B":

## 8. FRAME “B” assembly

TRANSMISSION assembly:

8.2 Untight the 3 bolts



8.3 Unify the transmission with the frame

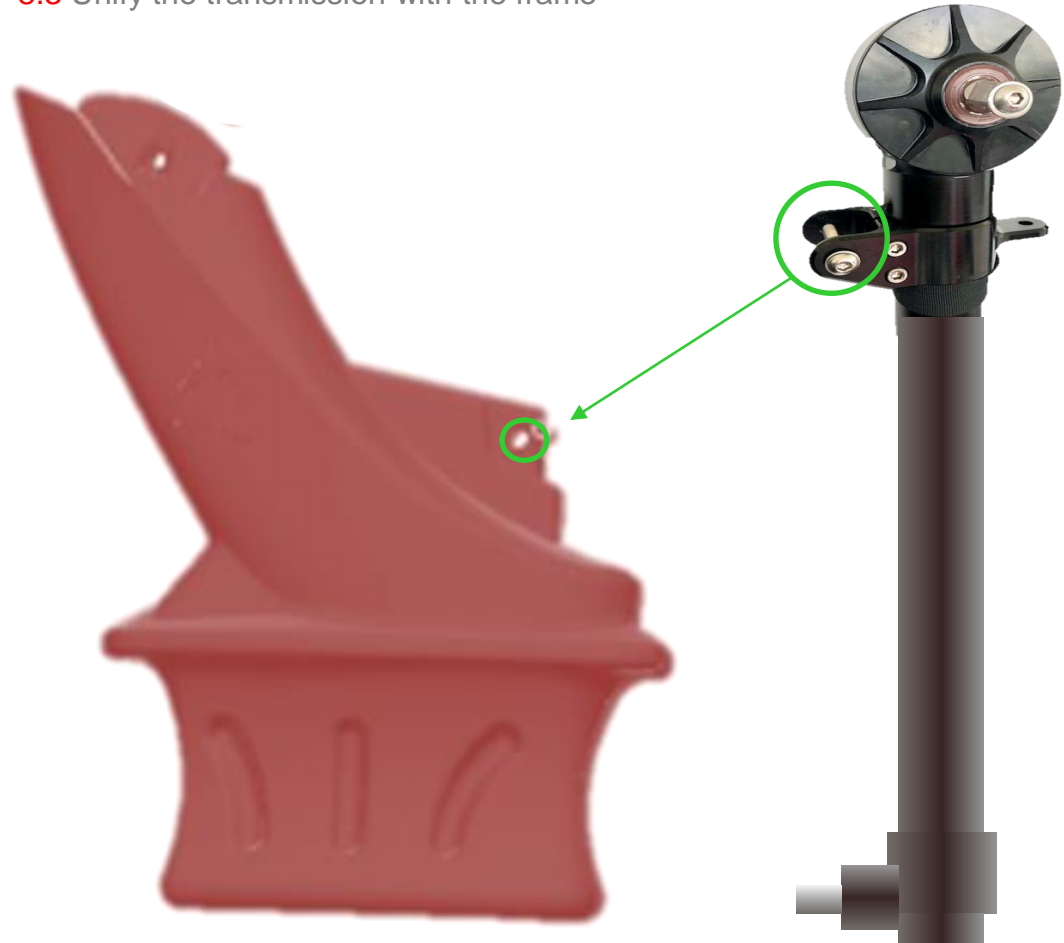



## 8. FRAME "B" assembly

Transmission LEVEL assembly:

8.4 Leave NO space between



## 8. FRAME "B" assembly



8.5 CHECK the transmission DIRECTION assembly:

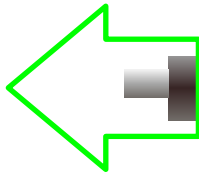

## 8. FRAME "B" assembly

### 8.6 Transmission ALIGNMENT:



Align with the white central marked line

From TOP side

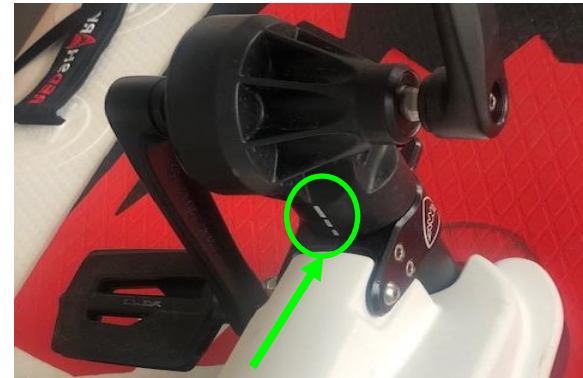

## 8. FRAME "B" assembly

### 8.7 Transmission screws TIGHTEN:

TIGHT the 3 bolts:



**TORQUE SPECIFICATIONS:**

**6 Newtons**



Tighten all the 3 screws



### 8.8. Bolt & Locknut

Please use a tool 13 (NOT INCLUDED)





## 8. FRAME "B" assembly

8.9 INSERT the frame in the REAR HOLE with a little air pressure in the board



Board with soft air pressure **0,5 psi**



### KEEP ATTENTION:

The A & B Holes surface, must be completely clean from dust, sand and other dirty elements. If not it could generate damages on the board skin. Please clean always before.

AVOID THE INTERFERENCES from the rudder and propeller with the board surface (holes A and B) if not it could generate damages on the board.

Suggestion: You can use a cloth rag to cover the rudder.



RECOMMENDATION:  
Please use a small STOOL  
(not included).

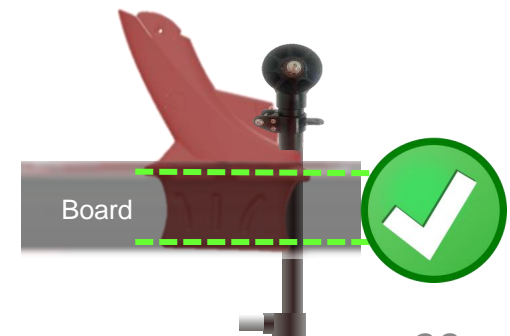

## 9. FRAME "C" assembly

9.1 CHOSE the frame piece "C":

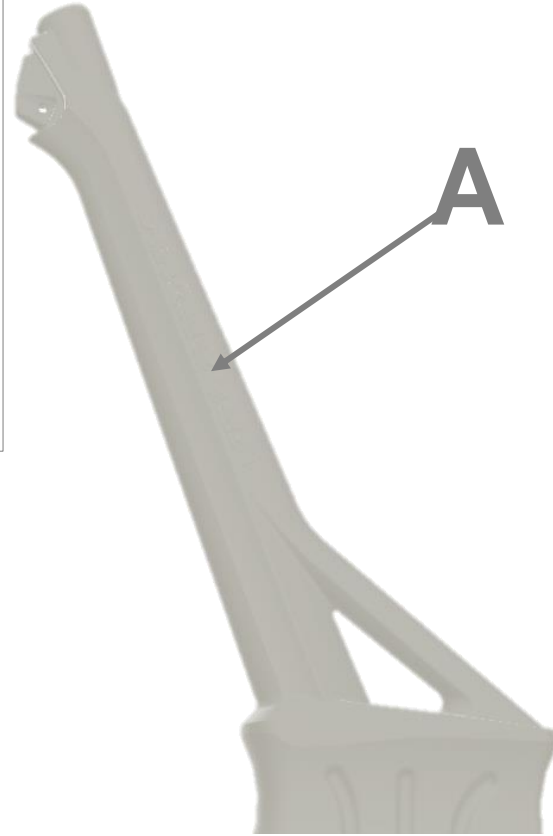
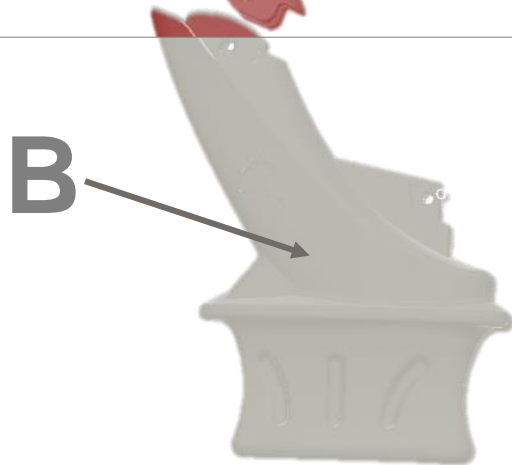
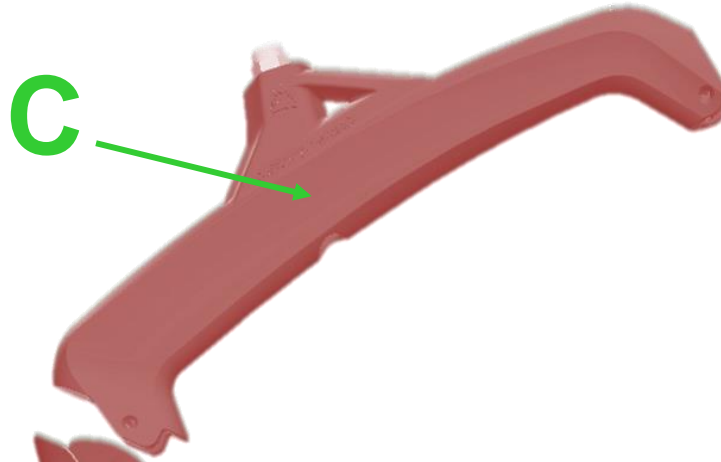

### 9.2 INSERT the frame “C” in to the frame “A” & “B”.



## 9. FRAME "C" REAR unión assembly

9.3 TIGHT the screw through tre two frames with the clamp using the LONGER Allen key (NOT INCLUDED)

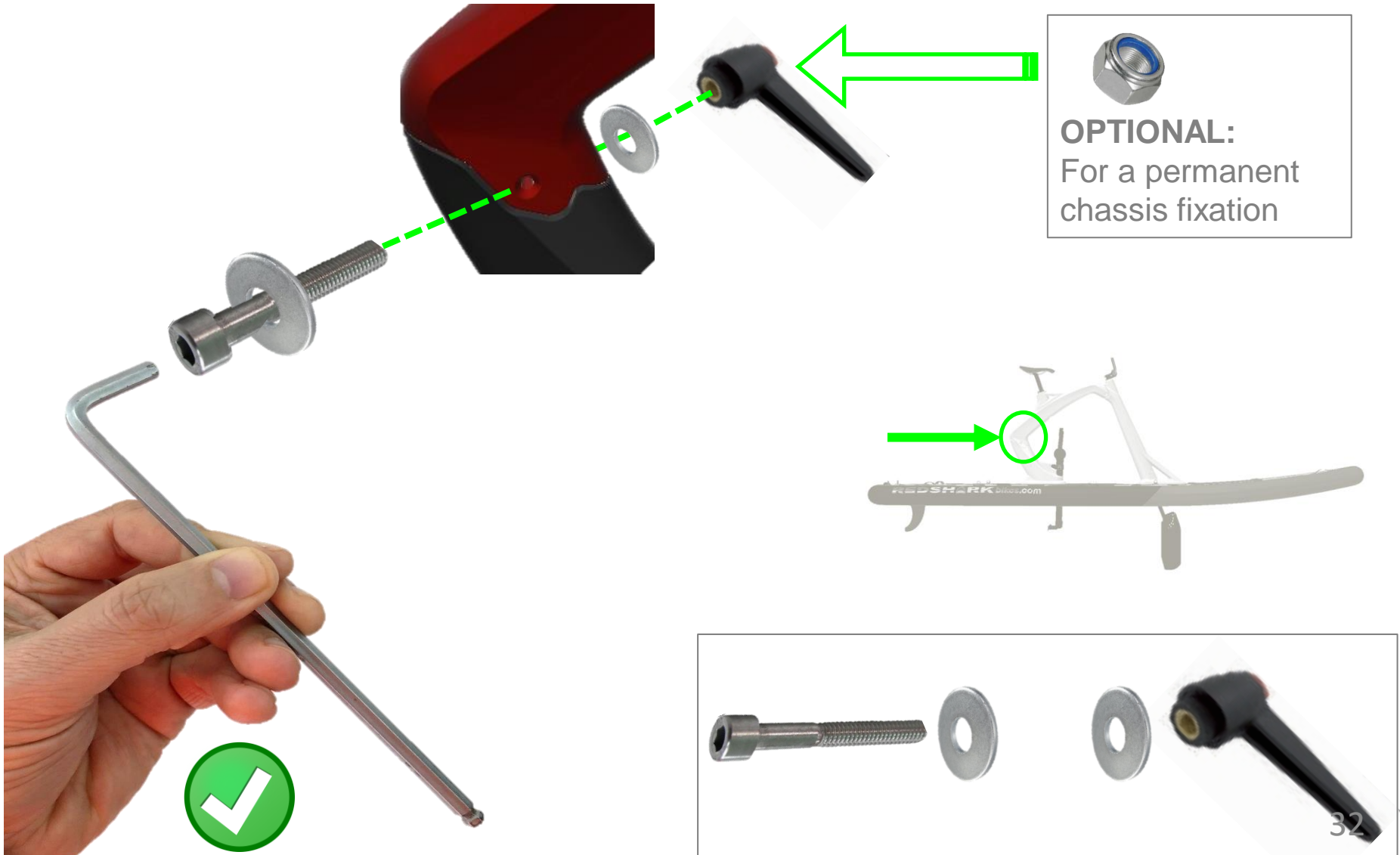



## 9. FRAME assembly (REAR union)

9.4 TIGHT the bolt STRONGLY

ATTENTION! TIGHT the Bolt: **FULL POWER**



TORQUE SPECIFICATIONS:

20 Newtons



## 9. FRAME "C" FRONT unión assembly

9.3 TIGHT the screw through tre two frames with the clamp using the LONGER Allen key (NOT INCLUDED)

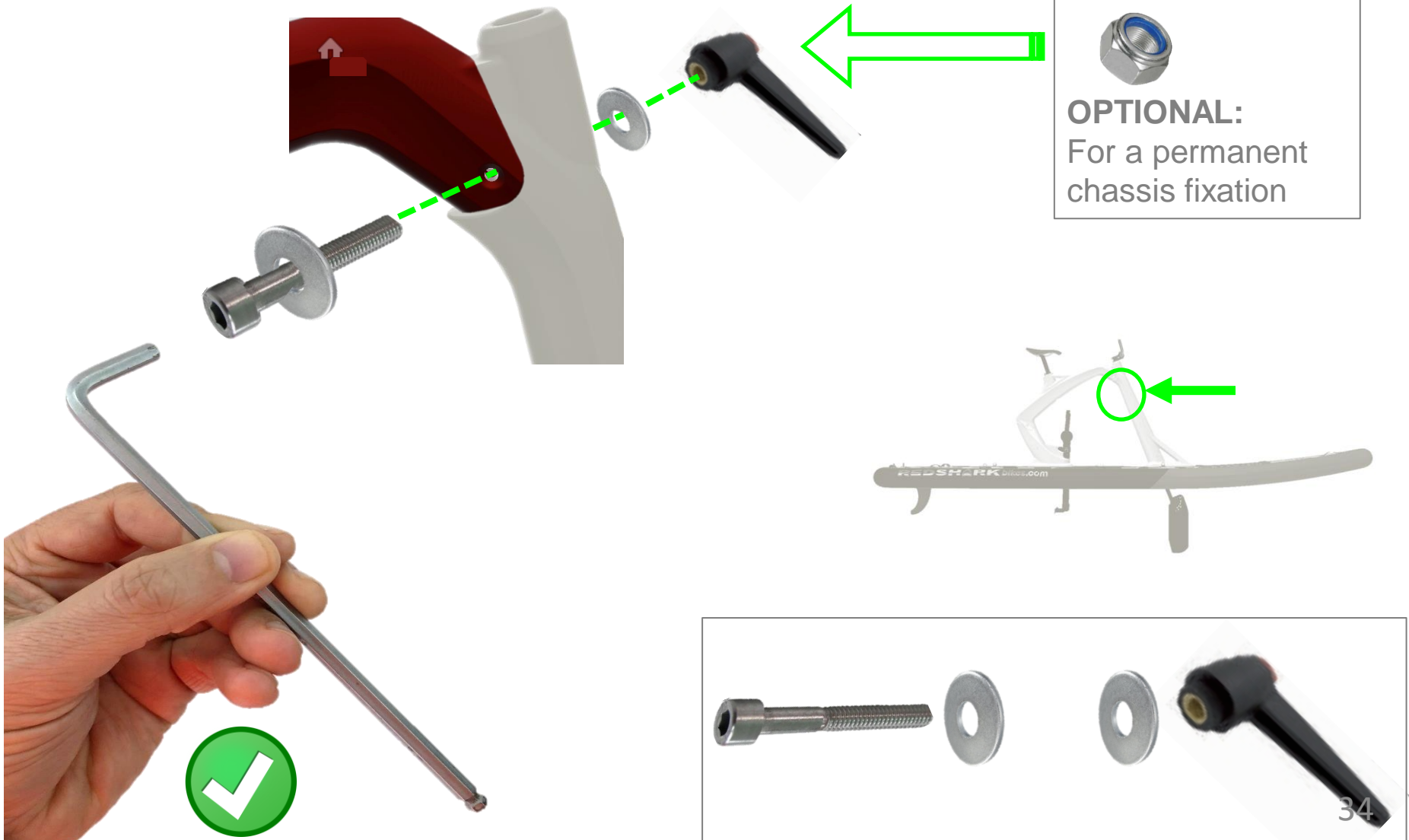

## 9. FRAME assembly (front union)

9.4 TIGHT the bolt STRONGLY

ATTENTION! TIGHT the Bolt: **FULL POWER**



TORQUE SPECIFICATIONS:

20 Newtons

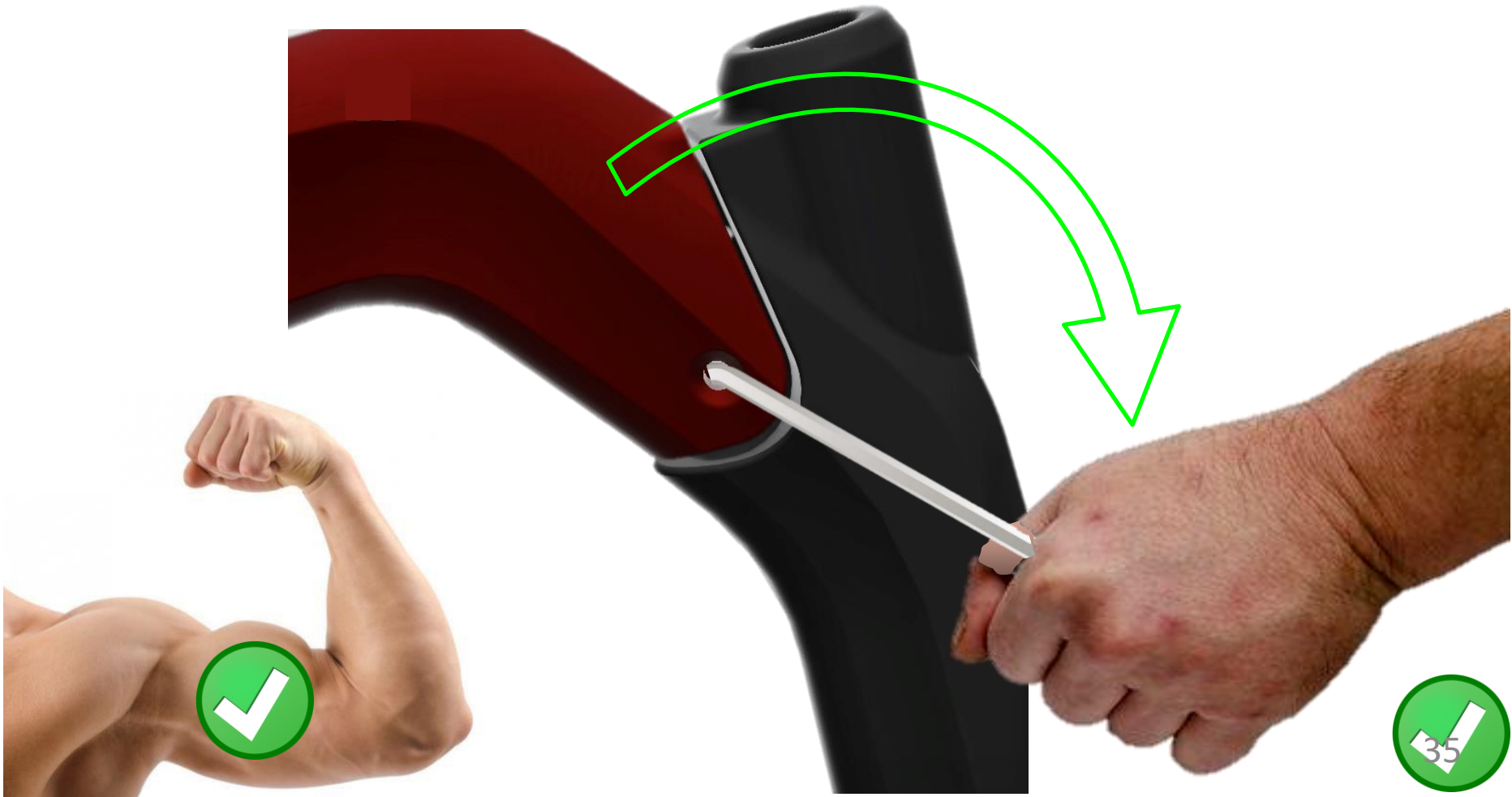

## 9. FRAME "C" REAR unión assembly

9.3 TIGHT the screw through to the 5 holes

10 screws



2 plates

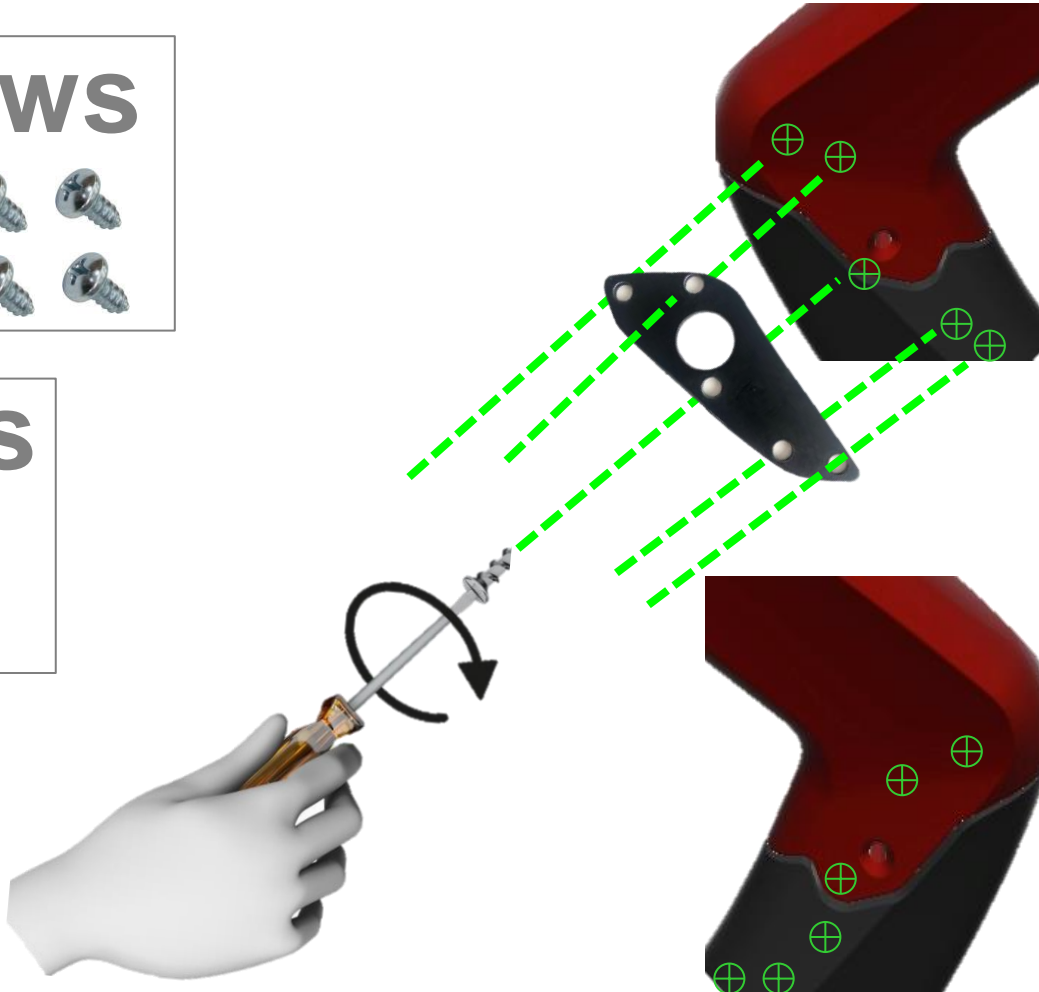

RIGHT side

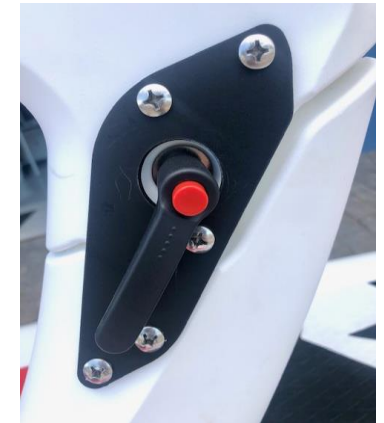

Repeat on the LEFT side



## 10. FRAME & BOARD (position)

10.1 Confirm the frame position: Must be in a vertical position ( $90^\circ$  towards the board)

FRONT view

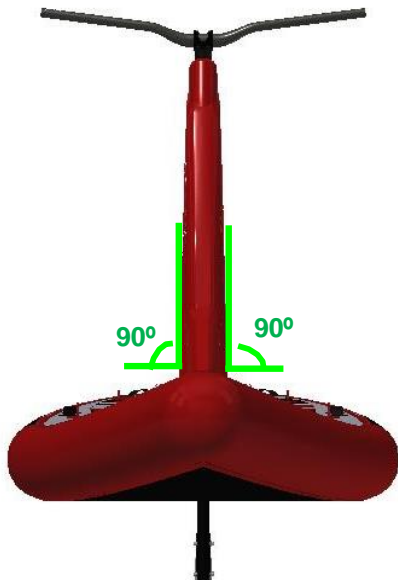

SIDE view

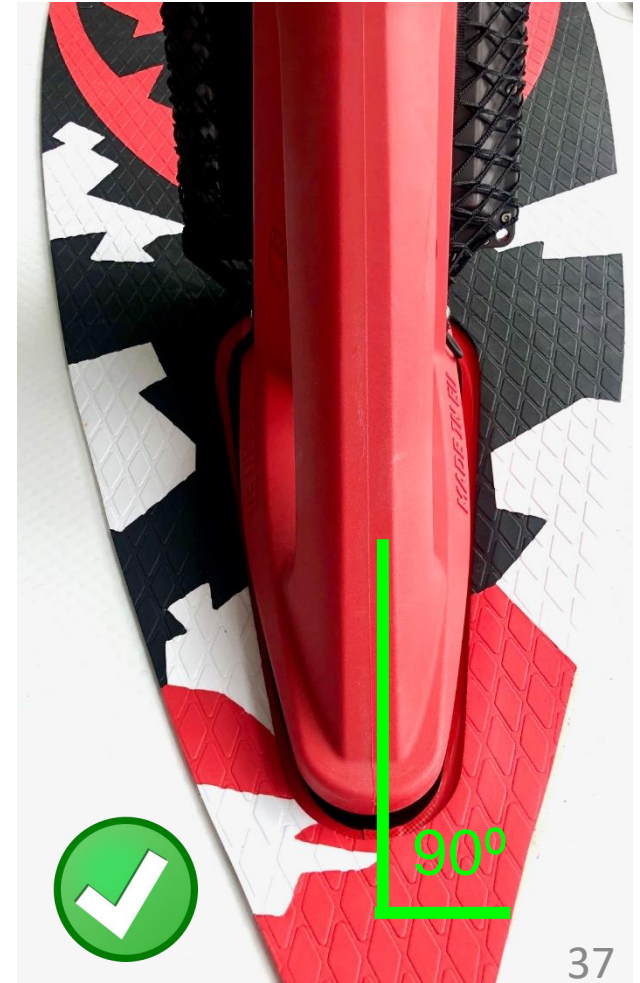

## 10. FRAME & BOARD

### 10.2. PUFF UP the FINAL AIR PRESSURE

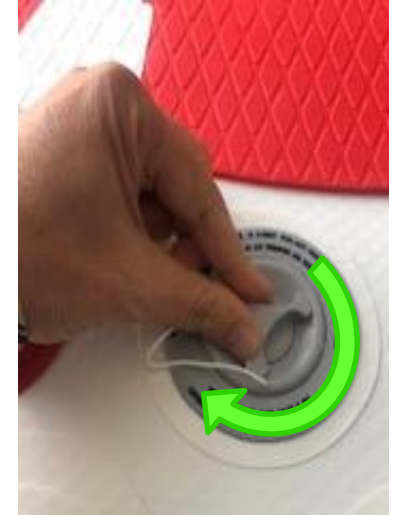
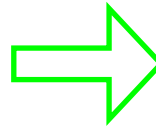

Pressure:

✓ **12 PSi** (warm countries)

✓ **13-14 PSi** (cold countries)

10.3. Screw the cap onto the valve



## 10. STRAPS assembly

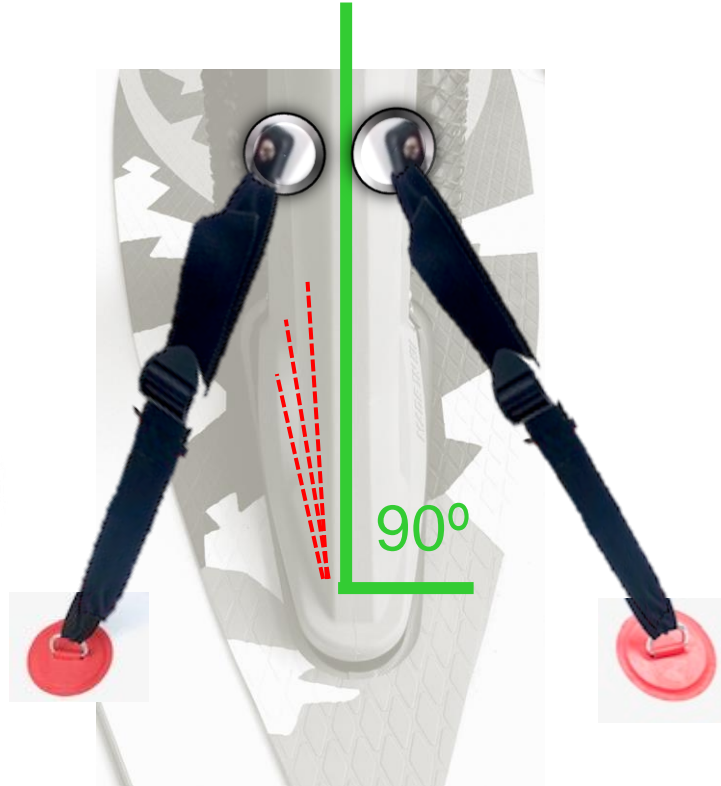
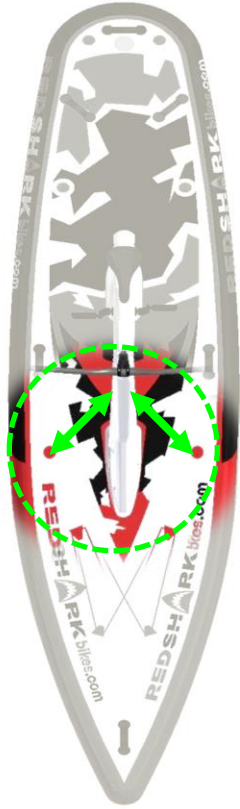

10.3 Put the chassis upright and tighten the belt Must be in a vertical position (90° towards the board)

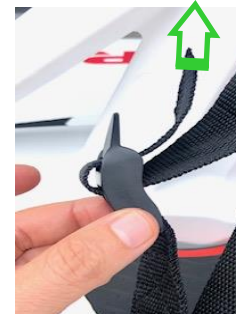



## 11. SADDLE assembly

11.1 Untight the bolt, adjust the seat to your position and tight the bolt.



11.2 SADDLE position adjustment (horizontal)



TORQUE SPECIFICATIONS:

7 Newtons



## 11. SADDLE assembly in the frame C

11.3 Open and adjust seat Post CLAMP position

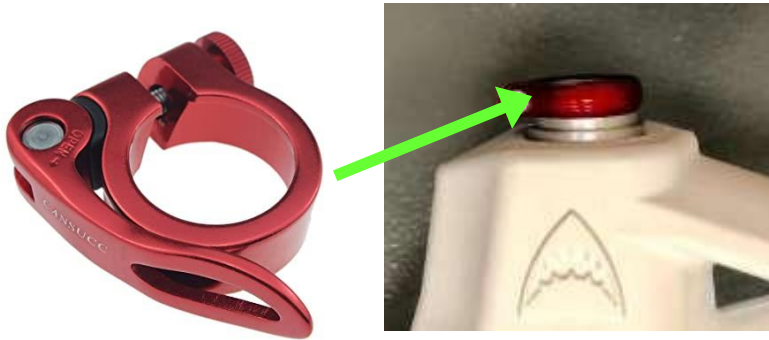

11.4 Check your height



11.5 TIGHT the post clamp



11.6. Check your position

Adjustment recommendations





## 12. How to fit CRANKS & transmission

### 12.4 Remove BOLT and WASHER

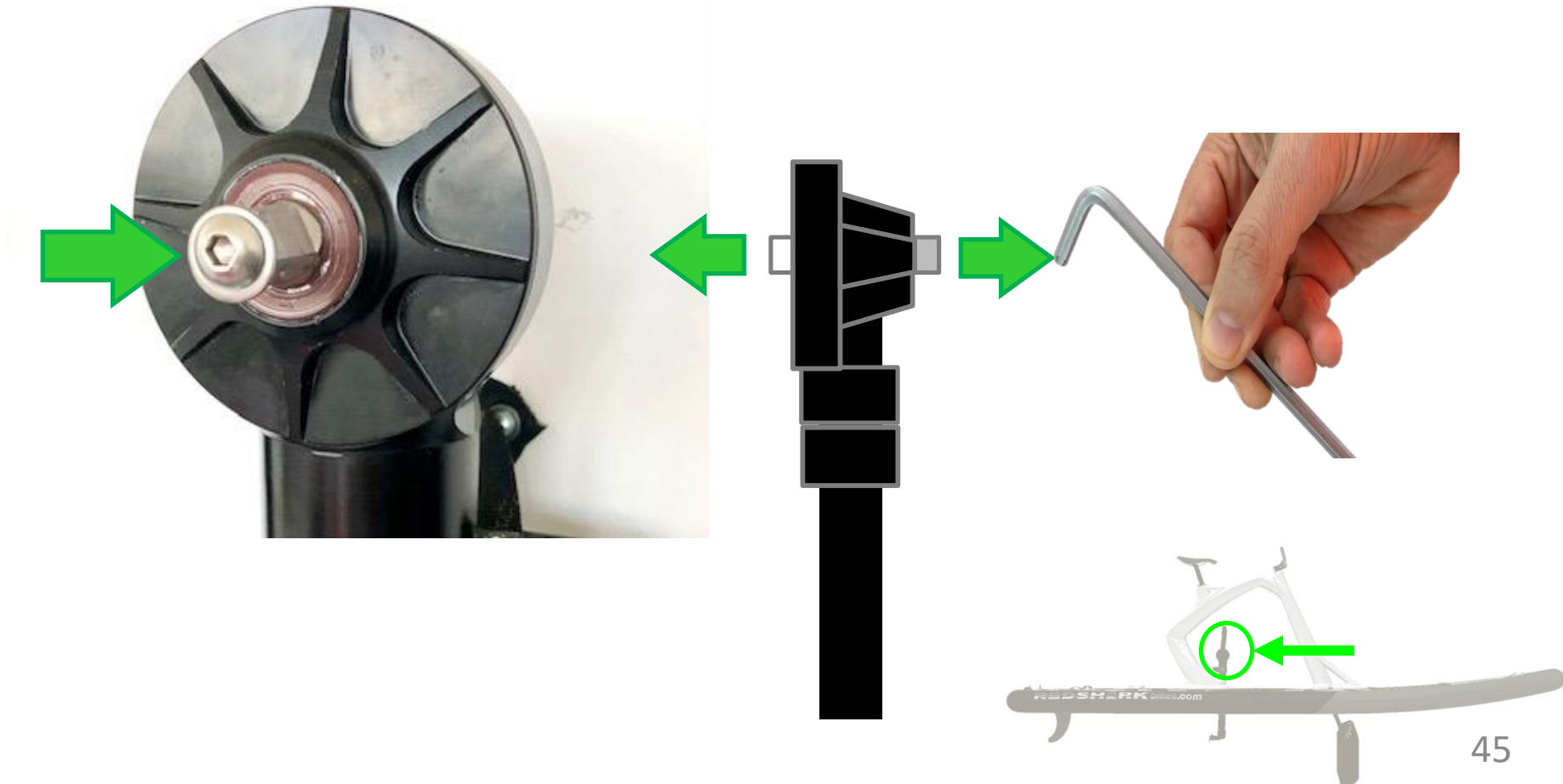

## 12. How to fit CRANKS & transmission

FRONT

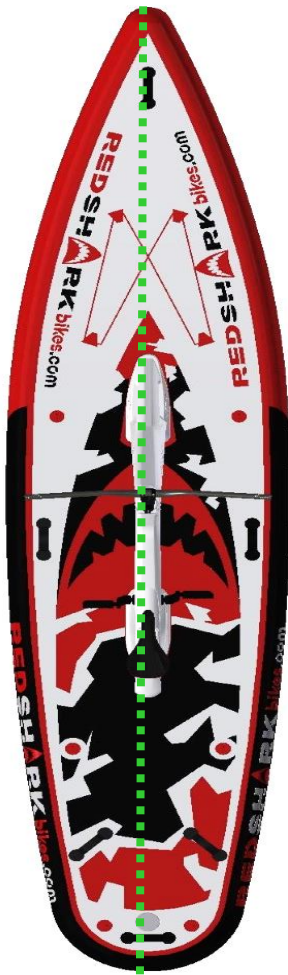

REAR

LEFT  
side

RIGHT  
side



LEFT side

12.4 Insert the crank in to the transmisión axel

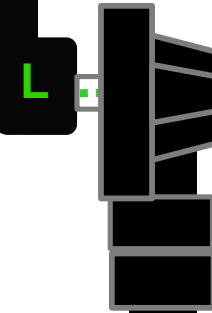

RIGHT side

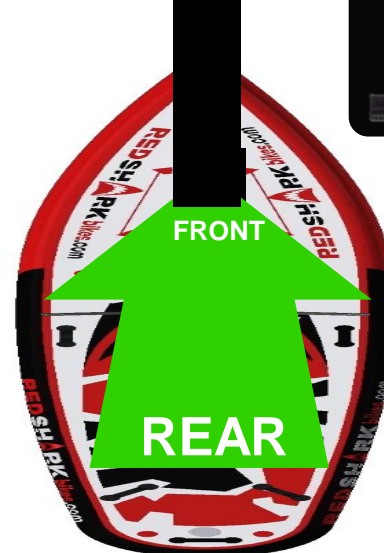

FRONT

REAR

## 12. How to fit CRANKS & transmission

### 12.5 Screw the bolt with the washer in to the transmisión axel



a. Insert the PEDAL crank

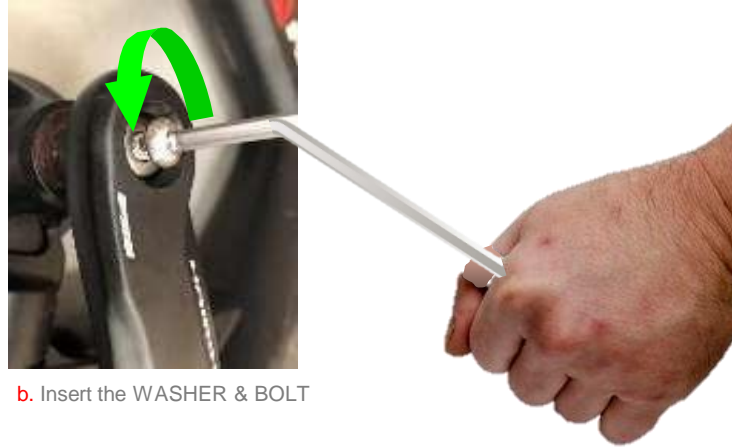

b. Insert the WASHER & BOLT



**TORQUE SPECIFICATIONS:**

**15 Newtons**



**IMPORTANT**

**Check regularly  
before riding**

Especially the first rides

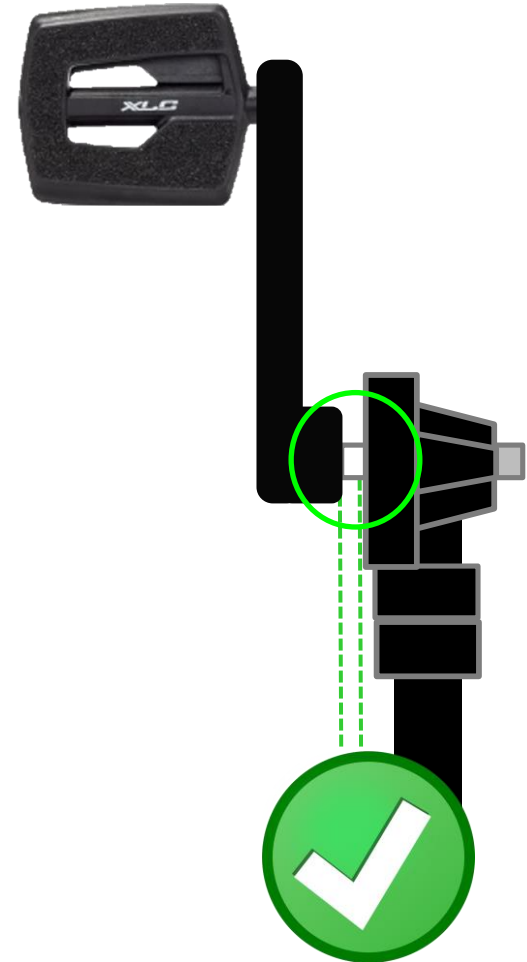

# ASSEMBLY INSTRUCTIONS

## 12. How to fit PEDALS

12.4 Insert the peddal in to the crank axel



IMPORTANT

Chek regularly  
before riding



LEFT pedal  
**tighten**  
**DIRECTION**



OPOSITE



Has a left hand thread

Turn anti-clockwise to tighten.

That means you always tighten the same way the crank rotates when pedaling when looking directly at the crank/pedal.



RIGTH pedal  
**tighten**  
**DIRECTION**

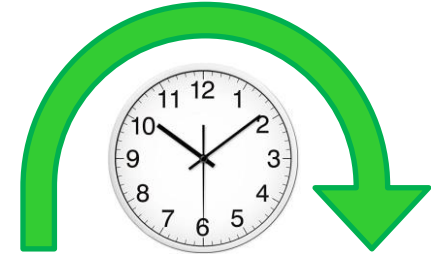

Has a normal thread

Turn clockwise to tighten.

# ASSEMBLY INSTRUCTIONS

## 13. PROPELLER assembly

### 13.1 Remove carefully the plastic protection



### 13.2. Remove the bold and washer



### 13.4 PROPELLER placement

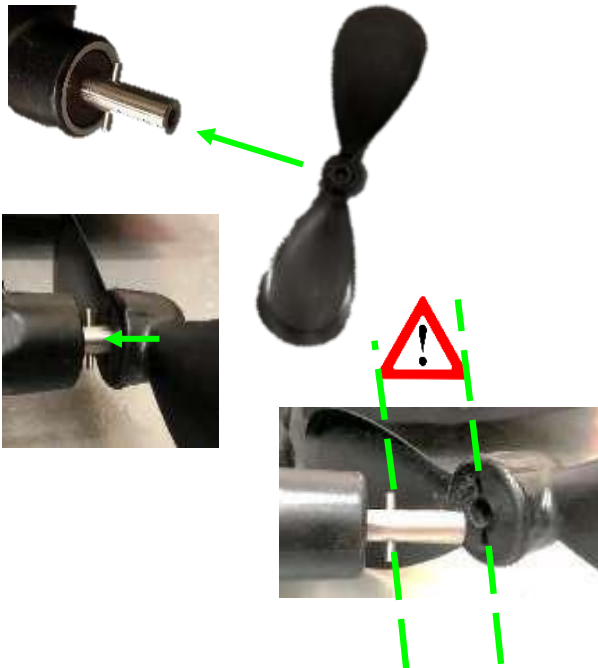

### 13.3 Needle placement

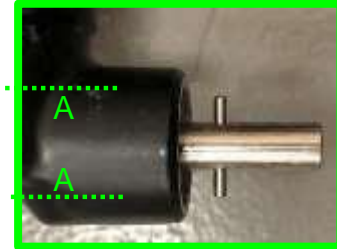

### 13.5 Tight the bolt and the washer



TORQUE SPECIFICATIONS:

**4 Newtons**





## 14. FIN assembly

**14.1** Insert the fin in the board (bottom rear) slot until the end. Slide the fin onto the bottom side of the board until the end and cross the pin until you hear a click.

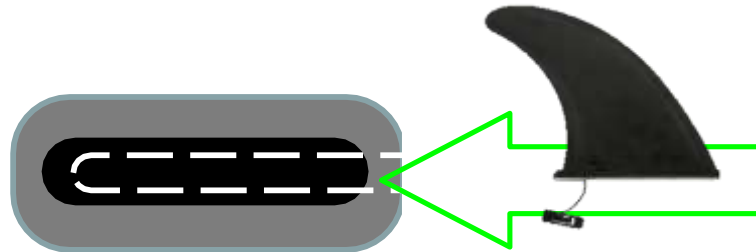

**14.2** and cross the pin on the hole fin until you hear a click.

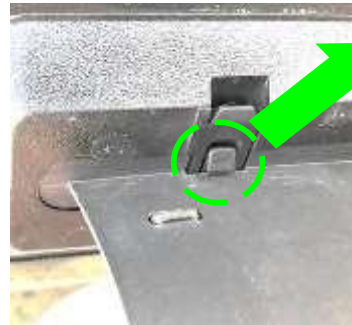

Click

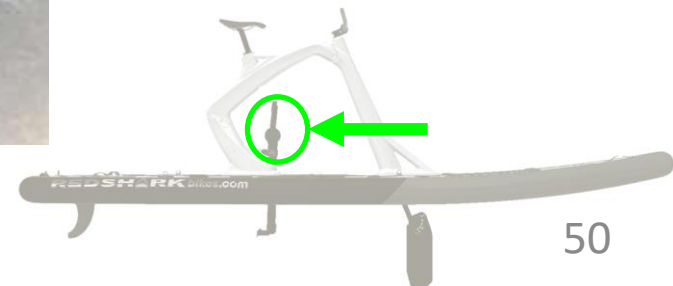

# TRANSPORT & manipulation

BE CAREFULL on the below elements



**A.** REMOVE the FIN

**B.** PROPELLER: in HORIZONTAL position

**C.** RUDDER: in "T" (HORIZONTAL position)

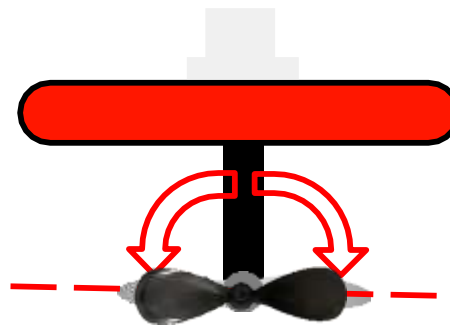

Keep the **PROPELLER** in **HORIZONTAL POSITION**

# TRANSPORT & manipulation

**NOTE:** TROLLEY is extra equipment

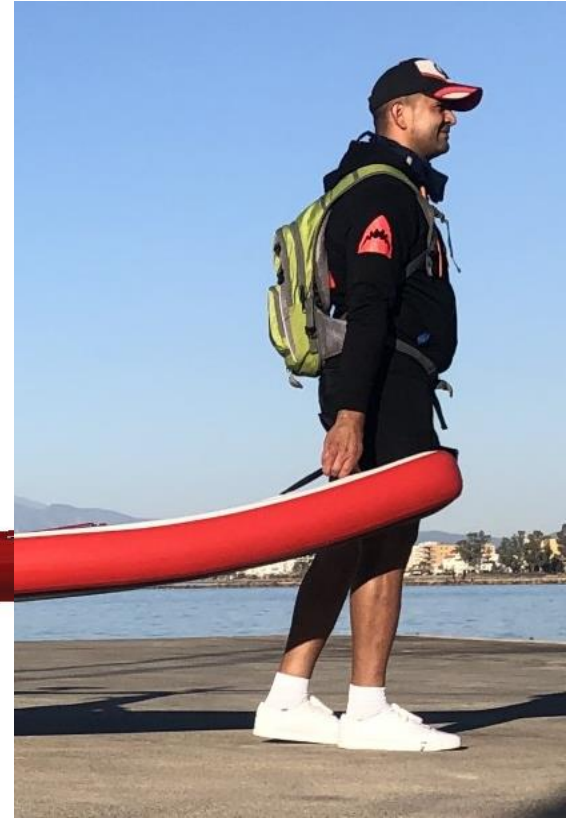

Trolley BELT



OPTIONS



Most  
recommended



MOST  
recommended



## 16. BEFORE RIDING check

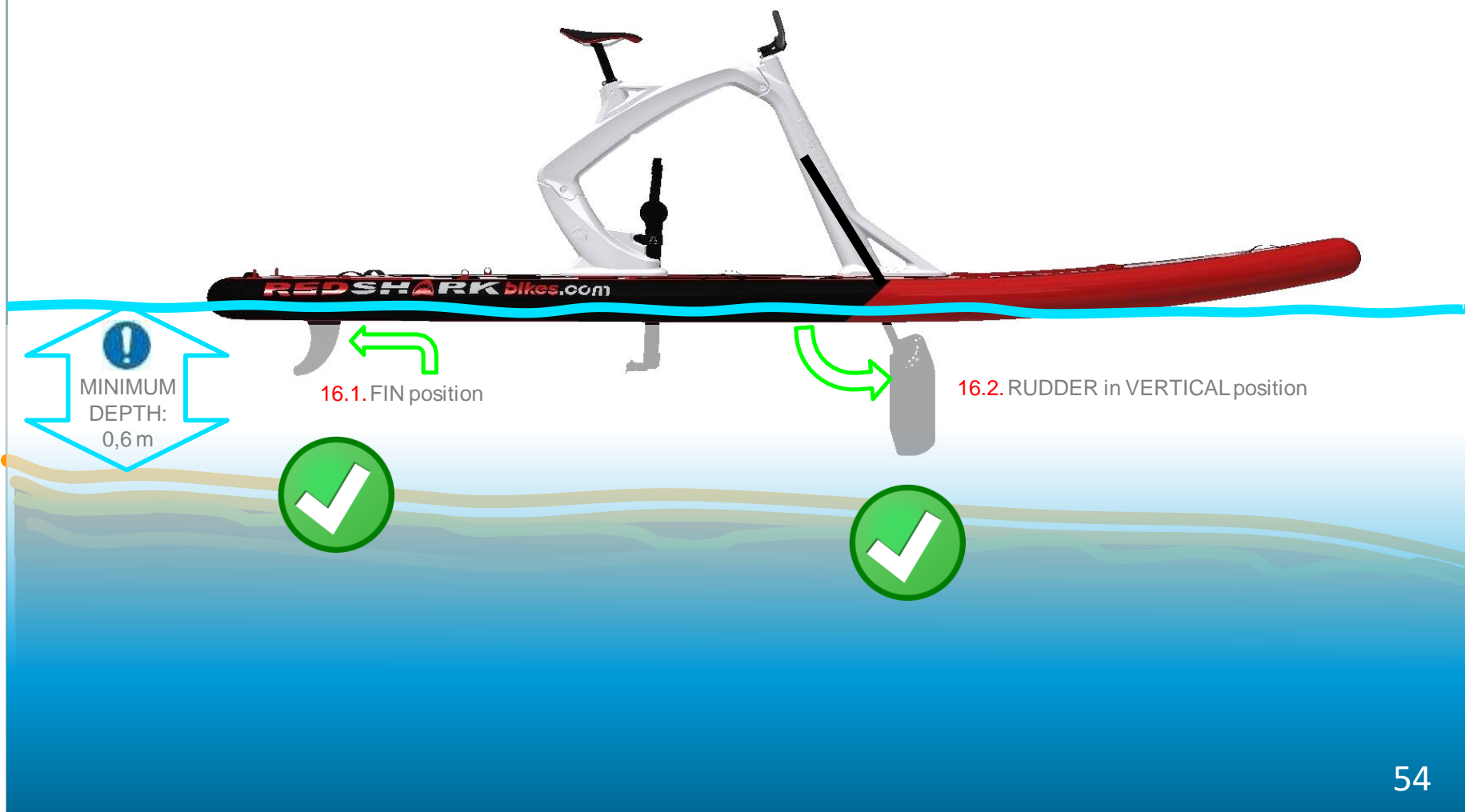



# TO GET ON instructions

 Before start, **PRACTICE THIS ACTIONS** until you really know, Do it on a calm water with no wind. First moments are the most stressful ones,

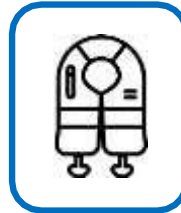
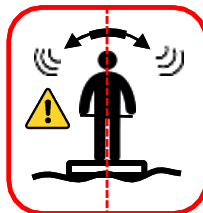

WEAR LIFE  
JACKET

**REDSHARK** bikes

**A.** From the BEACH:

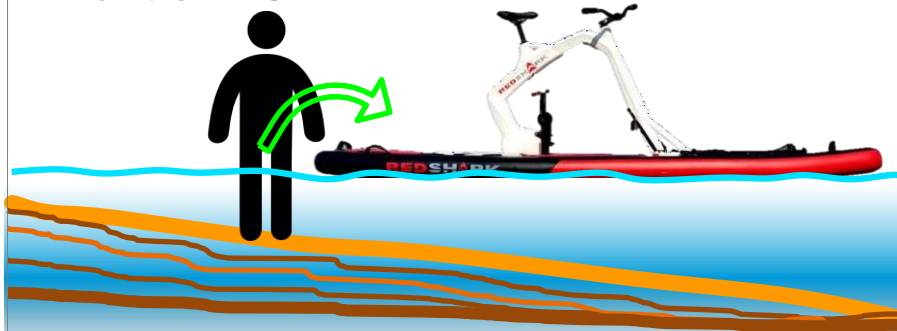

**B.** From the DEEP water:

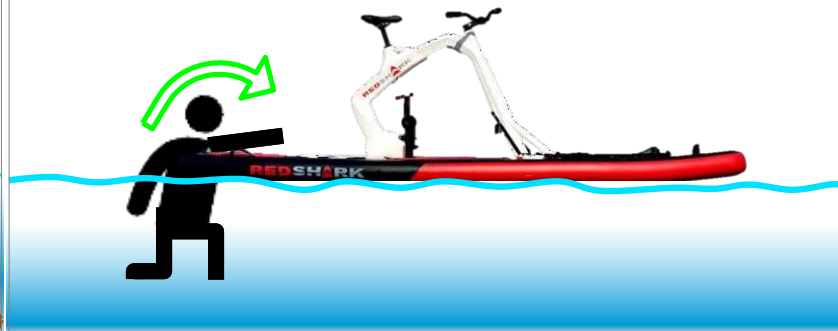

**C.** SEAT on top of the deck



**D.** TRANSFER  
your body in to the  
center



**E.** And GO!



Pedal straight smoothly but decide until you find your body rhythm relaxed. When you have to turn, don't stop pedaling and do it smoothly

# TO GET ON instructions

From a WHARF, boat or similar:

## A. Always parallel & from the side

Grab the handlebar and do not transfer the weight of your body (from the 2<sup>o</sup> foot on firm ground) until you have the 1st foot in the center of the board.

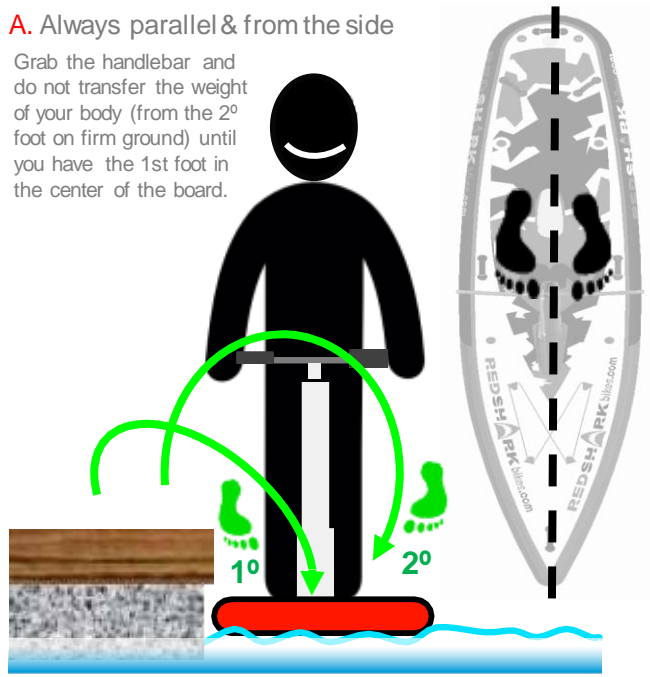

**PRACTICE THIS ACTION** is dangerous, some additional support from the wharf it will help you to know how to do it.



**PRACTICE THIS ACTION** with helmet, column protector and wear **LIFE JACKET**



## B. Balance centered and relax



For better balance, Keep **YOUR BODY** to the board center

**C. Pedal straight smoothly but decide until you find your body rhythm relaxed. When you have to turn, don't stop pedaling and don't do it smoothly**



### IMPORTANT NOTE:

Do it on a calm water with no wind. First moments are the most stressful ones, so you should ride smooth. As soon as you feel stable please turn (left or right) very smoothly.

**AFTER** being used  
Don't leave it in the water.



CLEAN ALWAYS AFTER USED  
WITH FRESH WATER



LEAVE IT ALWAYS IN THE  
SHADOW

If you leave in the water, algae and crustaceans  
can be hooked, electrolysis may appear, birds  
droppings and leaf can dirty the parts. Longer  
sun exposure can damage the units.



#### RECOMMENDATION

Please use a small STOOL (not included).

Keep it upright position **ON THE SHORE** or **ON THE GARAGE**.

# WARNINGS & PRECAUTIONS



## PROHIBITION

PROIBIDO / PROHIBICIÓN / VERBOT. KIELTO / VERBOD / DIVIETI / INTERDICTION / ZAKAZ / TILTÁS / FÖRBUD.



DO NOT USE IN  
OFFSHORE WINDS



DO NOT USE IN  
ELECTRIC STORMS



DO NOT USE IN  
OFFSHORE  
CURRENTS



DO NOT USE IN  
SWIMMERS AREAS



DO NOT USE IN  
WAVES or  
CURRENTS AREAS



## WARNING

ATENÇÃO / ADVERTENCIA. ACHTUNG / VAROITUS / WAARSCHUWING / AVVERTENZA / ATTENTION / OSTRZEZENIE / FIGYELMEZTETÉS / VARNIG



NO PROTECTION  
AGAINST  
DROWNING



AIR: 12 -14 psi

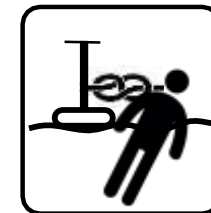

WEAR  
Flexible elements  
and clothes that  
cannot be tangled



## MANDATORY

OBRIGATÓRIO / OBLIGATOIRE / NUTZUNGSHINWEISE / PAKOLLINEN / VERPLICHT / OBBLIGATORIO / OBLIGATION / NORMA / KÖTELEZŐ / OBLIGATORISK



FIRST  
READ MANUAL  
INSTRUCTIONS



SWIMMERS  
ONLY

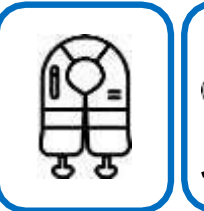

WEAR  
LIFE JACKET

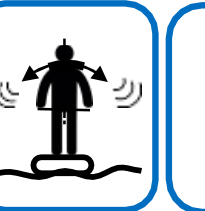

DEVICE  
REQUIRES  
BALANCING SKILLS

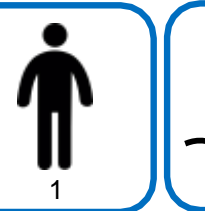

ONLY 1 PERSON

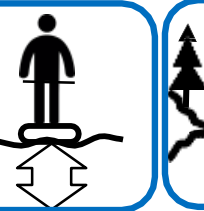

MINIMUM DEEP:  
0,6m

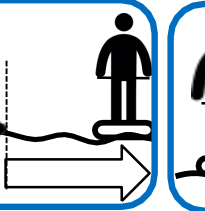

MAXIMUM: 300m  
from the coast

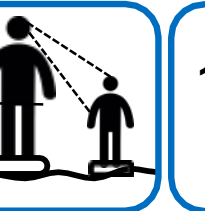

UNDER 18 years old  
MUST

BE ACCOMPANIED capacity110 kg  
BY AN ADULT



Max load

This product is a Personal Water Craft

and in France is under the "engins de plage (Division 240 - article 240-1.02)" category.



## **WARNING!**

Training is required prior to use of this product.

You must understand and accept the risks involved before participating in the water bike riding.

Always wear an approved Personal Flotation Device

NEVER use the Red Shark to go further than you can swim, on your own power.

Do not reach into openings, rudder borders or rotating parts.

Like any other device, there is a chance of product failure, always ensure that such failure will not put you in danger

Never use under the influence of drugs narcotic substances or alcohol

Use only in calm and sheltered waters.

Children and minors under 18 years old, must be used only under adult supervision.

NEVER use the Red Shark near fishing threads, branches, seaweed, plastics, loose clothing or OTHER objects from getting into the propeller.

Always rinse or run in clean fresh water after use. Do not use harsh chemicals to clean any Red Shark products

When cleaning the propeller area, make sure some one is not turning the pedals Do not keep Red Shark products under direct sunlight or in a parked vehicle for extended period and always store from 10°C to below 22°C

It is forbidden to use the water bicycle to people who can not swim.

Never wear clothing that may become entangled with any protruding element of the bicycle, if it overturns and stays stuck under the water, you can drown. During the use, no one should touch, the propeller and the rudder (can cause injuries).

Do Not use in areas occupied by swimmers or divers.

NEVER use the Red Shark if you may feel dizzy or lose consciousness.

Avoid large tides or boat trails hitting your bike since this could tip your water bike.

If you have no experience or you are not very skilled on swimming , never go alone and go to water areas that are not deeper than your neck.

Do not use in strong currents, heavy swell or impaired visibility, waves or offshore wind.

Check all the screws regularly before to depart.

Read the user manual in full.





## PRECAUTIONS:

Before leaving, always check that the weather forecast is appropriate for this activity.

### FIRST TIME NOTES:

Do it on a calm water with no wind and with the comfort propeller. First moments are the most stressful ones, so you should ride smooth and constantly in a straight line. As soon as you feel stable please turn (left or right) very smoothly but with a constant pedalling.

You may have a feeling of having a very smooth roll, this is normal, but it is misleading, you will feel, after 30 minutes of pedalling fairly at a medium rate, the strength on your legs.”

Using a Red Shark Bikes products on the water can be dangerous and involves certain risks which often cannot be predicted or avoided. Those risks include, but are not limited to, personal injury or death, property damage, which may result from, loss of control, collisions with other users or watercraft, swimmers, and natural and man-made objects and/or animals/plants. By choosing to use a Red Shark Bikes product, you assume these risks and thereby need to know and practice water safety rules, responsible motoring, and proper use and maintenance of your Red Shark Bikes product(s) to reduce these risks. Since it is impossible to anticipate every situation or condition which can occur while some elements under in water, Red Shark Bikes can make no representation or warranty about the use and safety of Red Shark Bikes products under all conditions.

### REGISTERING YOUR Personal Water Craft as a vessel:

Please the rules and in certain municipalities, states or countries, it is required that you register your water bikes, kayaks, SUPs, canoes, scooter surfs motorized, with your local licensing body. Please be sure to take the necessary steps to comply with local laws and regulations that apply to your water bike.